

Dustie



Dustie Air Cleaner

瑞典达氏空气净化器

DK2 Air Cleaner

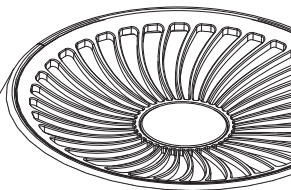

Please read this operating manual,
Before using this product.

(请在使用本产品前，阅读本操作手册)

Safety Instructions

- Please read the operating manual carefully before use and keep it properly for future reference.
- This manual is applicable to the DK2 series models. Please operate according to the instructions of the purchased model.
- When using electrical appliances, we should have basic safety knowledge to avoid fires, electric shocks and other injuries. You are expected to follow the instructions below.



Place the product at least 10 cm away from the obstructing object.



Do not cover the surface of the product with objects such as towels, to keep the surrounding air flowing.



Use the product safely to avoid fires, electric shocks and other injuries.



Please use this product in a room on a horizontal desktop with air circulation.



Do not place the product in a place where it is easy to touch the curtains.



The product must be erect in operation.

Safety Instructions



Do not operate the product with wet hands. Do not wash the product directly with water.



It is forbidden to block the inlet and outlet with foreign objects. The product contains an internal high-speed rotating motor, please avoid accidental injury or damage to the product.



It is forbidden to use the air purifier as a toy for children to play.



If the power cord is damaged, in order to avoid danger, it must be replaced by the manufacturer's maintenance department or a professional in a similar department.



Do not use the product in a bathroom or in a place with gas.



Non-professionals or unauthorized repair personnel are not allowed to repair or modify the product by themselves.

【 Preparation prior to use 】

- Take out the product from its packing box and place it on a table or flat floor. The body of the product should be at least 60cm or more away from the walls or other home furnishing to promote air circulation.
- Prevent children or people who do not understand this product from using it.
- You can start to use the air cleaner and enjoy the fresh air.

Caution: Please remove all packing materials before use so as not to block the air inlet and outlet.

Names and specifications of parts

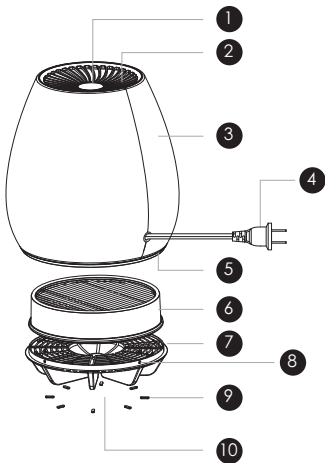

① Button

② Air outlet

③ Host

④ Power cord

⑤ Ambient Light

⑥ Filter

⑦ Inlet grille

⑧ Buckle

⑨ Foot pad

⑩ Inlet

Names and specifications of parts

Product	Dustie Air Cleaner
Model	DK2
Rated voltage	220V~/50Hz
Input power	50W
Dimensions	245(Width) X 280 (Height) mm
Mode of dust collection	Unidirectional vortex circulation and filtration system
CADR of particular matters	120m ³ /h (*1)
Particle energy efficiency	Qualified level (*2)
Applicable area (m ²)	8-14 m ² (*3)
Weight	2.35kg

* Note 1: Section 5.3 of the implementation standard GB/T 188012015

* Note 2: Section 5.5.2 of the implementation standard GB/T 188012015

* Note 3: According to the relevant provisions of GB/T 188012015,
the applicable area is equal to $(0.070.12 \times \text{CADR})$

* Note 4: The product meets the safety standards of GB4706.1-2005/GB4706.45-2008

Operating instructions

I. Product Operation

1. Place the machine on the horizontal desktop and make sure to follow the precautions on the first page.

2. Plug in the power

Plug the purifier power cord into a power socket with a voltage of 220V and a frequency of 50Hz, and ensure good contact.

Note: Do not plug or unplug with wet hands to avoid electric shock. Unplug the power cord when moving the machine.

3. On/off

Press and hold the power button for 3 seconds, the power indicator light is on, the product is turned on; press again and hold for 3 seconds, the product is turned off.

4. Wind speed

Touch the power button to switch the product wind speed. Each time you touch the button, the wind speed will shift into a higher gear, and the corresponding indicator lights up; and so on; the default gear is gear I.

5. Ambient light on/off

Tap the power button twice to turn the ambient light on or off. Each time the power is turned on, the ambient light is default to "on".

6. Filter replacement/reset

When the filter usage expires, the product will automatically enter the filter warning mode. At this time, the red light at the top of the product will light up and flash, and the motor will stop rotating, indicating that you need to replace the filter to prevent the used old filter from affecting your health.

(Reset method: Press and hold the power button, and unplug the power plug and plug it in again to release the filter warning mode.)

II. Filter replacement

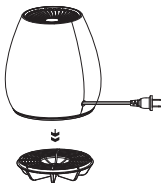

1. Turn off the machine, unplug the power, and take off the inlet grille.

- A. Press and hold the product power button for more than 3 seconds to turn off the machine;
- B. Unplug the product power cord;
- C. After turning the product upside down, gently pull the air inlet grille out in the direction of the arrow.

2. Remove the old filter

Hold the filter handle and remove the old filter in the direction of the arrow.

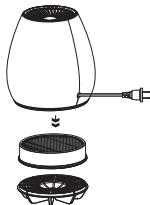

3. Take out the new filter

Use a pair of scissors to open the sealed bag of the new filter and take out the new filter.

product maintenance

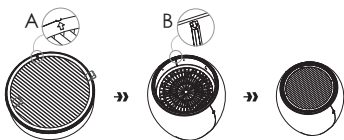

4. Install the new filter

Hold the handle of the new filter with both hands and place it vertically into the filter slot of the main unit.

Note: The arrow A of the filter should be placed vertically at the position of the filter slot B.

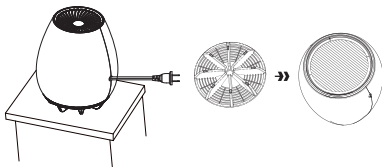

5. Install the inlet grille

Place the inlet grille vertically into the main unit in the direction of the arrow. Then place the product on a horizontal desktop and plug it in again.

Note:

If the red light still flashes after replacing the filter, you need to manually remove the filter warning mode before you can use it! Press and hold the power button, and plug the power cord into the mains socket and unplug it to remove the filter warning mode. Then you can safely continue to use it.

III. Cleaning and Maintenance

Please unplug the machine and ensure that the product is off before maintenance.

Install according to the filter sticker to avoid mistakes.

It is best to wear gloves when replacing the filter element, and put the old filter in a plastic bag and dispose of it according to the garbage classification to prevent secondary pollution of the environment.

If not regularly check the cleaning and replacement filter will affect product use and life.

Daily cleaning

Please use a soft, dry cloth to clean the machine;

Use a soft, dry cloth to clean the dust from the air inlet and air outlet regularly to prevent dust accumulation.

Replace the filter

Maintenance of the HEPA filter:

Do not wash the filter;

During use, do not use sharp objects to puncture the HEPA filter. This will reduce or even damage the filtering capacity of the filter. When the replacement light is on, please confirm and replace the filter.

Special hints:

Do not install the used filter element in reverse, otherwise the dust adsorbed by the filter element may be sucked out by the wind and cause pollution.

Common problems

Common problem	Troubleshooting	Solution
The machine is not running	<ul style="list-style-type: none">● The power is not plugged in, or the socket is not in good contact.● The filter life has expired or the filter is too dirty.	<ul style="list-style-type: none">● Plug the power and ensure good contact.● Press and hold the power button while plugging the power cord into the mains socket and then unplug it.
Loud noise	<ul style="list-style-type: none">● Check to see whether the filter blocked.	<ul style="list-style-type: none">● Replace with a new filter or unblock the filter.
Poor smoke and odor removal effects	<ul style="list-style-type: none">● Low smoke removal efficiency.● Filter service life has expired.● The air inlet is blocked by foreign matter.● The use area exceeds the machine use area.	<ul style="list-style-type: none">● Please make sure the filter is installed in place.● Please replace the filter element in time.● Please remove foreign matter from the air inlet.● Please use it within the appropriate area.

- If you need services or wan to purchase filters and other supplies, please call our customer service line 4009-21-3058.

安全重要提示

- 使用前请详细阅读本操作说明指示，并妥善保管，以供日后参考。
- 本说明书适用于DK2系列型号，请依所购买机型操作。
- 当我们在使用电器用品时，应具备最基本的安全常识，以避免火灾、触电以及其他伤害的发生。

因此，请遵守以下指示



请将本产品放在距离阻挡物体相距至少10cm的地方。



产品表面请勿覆盖毛巾等物体，保持周围空气畅通。



使用电器用品应注意避免火灾，电击和伤害的危险。



请将本产品放在房间水平桌面和空气易循环的地方使用。



请勿将产品放置在易碰到窗帘的地方。



本空气净化器必须直立使用。

安全重要提示



严禁用湿手进行操作，禁止用液体直接清洗。



禁止进出口有异物。产品内部含有高速旋转的电机，防止意外伤害或损坏产品。



禁止将空气净化器作为玩具给儿童玩耍。



如果电源软线损坏，为了避免危险，必须由制造商、其维修部或类似部门的专业人员更换。



禁止在浴室或有燃气的地方使用本机。



非专职人员或未授权修理人员，不得自行修理或改造本机。

【使用前准备工作】

- 将空气净化器从包装盒中取出，置于桌面或平坦地板上。机体离墙壁或其他家居至少60公分以上，利于空气循环。
- 避免儿童或不了解本产品的人使用。
- 您可以开始使用空气净化器，畅享新鲜空气。

注意：使用前请移开所有包装材料以免堵住进出风口。

部 品 名 称

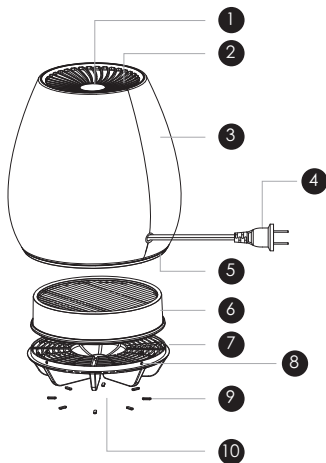

- | | | |
|--------|-------|------|
| 1 按键 | 2 出风口 | 3 主机 |
| 4 电源线 | 5 氛围灯 | 6 滤网 |
| 7 进风格栅 | 8 弹扣 | 9 脚垫 |
| 10 进风口 | | |

部 品 规 格

产 品	Dustie 达氏 空气净化器
型 号	DK2
额 定 电 压	220V~/50Hz
输 入 功 率	50W
尺 寸	245(宽)X280(高) mm
集 尘 模 式	单向涡流循环过滤系统
颗粒物CADR	120m ³ /h (*注1)
颗粒物能效	合格级 (*注2)
适用面积 (m ²)	8-14m ² (*注3)
重 量	2.35kg

* 注1：执行标准GB/T 18801-2015之5.3

* 注2：执行标准GB/T 18801-2015之5.5.2

* 注3：根据GB/T 18801-2015相关条款

适用面积等于 (0.07-0.12*CADR)

* 注4：产品符合GB4706.1-2005/GB4706.45-2008之安全标准

操作指导与产品维护

一、产品操作

1. 将机器放在水平台面上，并确保遵照第一页的注意事项后使用。

2. 插电源

请将净化器电源线插头插入电压为220V,频率为50Hz的电源插座中，并保证接触良好。

注意：不要用湿手插拔插头，以免触电。移动机器时，要拔掉电源插头。

3. 开/关机

长按电源键3秒，电源指示灯亮，产品开机；再长按3秒，产品关机。

4. 风速

轻触电源键，可切换产品风速，每轻触一次档位加一，对应指示灯亮起；如此循环；每次开机默认为1档风速。

5. 氛围灯开/关

连续轻触电源键两下，可切换氛围灯的亮与关。每次开机默认为开启。

6. 滤网更换重置

当滤网使用到期时，产品会自动进入滤网警示模式，此时产品顶部会亮红灯并闪烁，电机停止转动，表示您需要更换滤网，以防止用过的旧滤网影响到您的健康。

（重置办法：按住电源键不放，同时拨下电源插头再插电，即可解除滤网警示模式）

操作指导

二、滤网更换

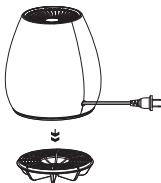

1. 关机，拔电源下，取进风格栅。

- A. 按住产品电源键大于3秒钟，关机；
- B. 拔掉产品电源线；
- C. 将产品倒置后，轻轻用力将进风栅格沿箭头方向拔出。

2. 取出旧滤网

握住滤网提手，将旧滤网沿箭头方向取出。

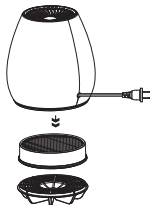

3. 取出新滤网

用剪刀打开新滤网的密封袋，取出新滤网。

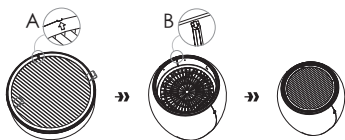

4. 装入新滤网

双手握住新滤网的提手，垂直放入主机的滤网槽内。

注意：要将滤网的箭头A对准滤网槽B位置垂直放入。

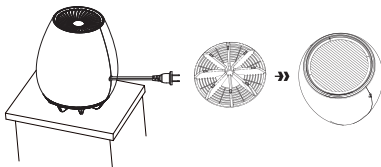

5. 装回进风格栅

将进风格栅沿箭头方向垂直装入主机。然后将产品正放于水平桌面上，重新插电使用。

提醒：

如果红灯闪烁时更换完滤网，需要您手工解除滤网警示模式才可使用！按住电源键，同时对准市电插座做一次插拔电源线插头的动作，解除滤网警示模式，之后可放心继续使用。

三、清洁与保养

滤网维护前请拔电，确认产品是关机状态。

依滤网贴纸要求安装，避免装错。

更换滤网组件时最好佩戴手套，并将旧滤网用塑胶袋装好后按垃圾分类废弃处理，以防旧滤网内的污染物对环境造成二次污染。

未定期检查清洁更换滤网，会影响产品使用及寿命。

日常清洁

请使用柔软干布清洁；

请定期使用柔软干布清洁机身及进风口/出风口的灰尘，防止灰尘积聚。

更换滤网

HEPA网的维护：

请勿水洗滤网；

使用过程中，请勿用尖物对HEPA滤网进行刺扎，这样会降低甚至破坏滤网过滤能力；

当更换灯亮起时，请及时确定并更换。

特别提醒：

请勿将已使用过的滤网组件反向安装使用，否则滤网组件所吸附的灰尘可能会因风力逃逸吸出，造成污染。

常见问题

常见故障	常见原因	解决方法
机器不运行	<ul style="list-style-type: none">● 电源未插，或插座接触不良。● 滤网寿命过期或滤网太脏污。	<ul style="list-style-type: none">● 电源未插请插好电源插头，并确保接触良好。● 按住电源键，同时将电源插头从市电插座上拔插一次。
噪音大	<ul style="list-style-type: none">● 滤网是否堵塞。	<ul style="list-style-type: none">● 更新新滤网或排出堵塞物。
除烟，除臭效果差	<ul style="list-style-type: none">● 除烟效率低。● 滤网使用寿命已到。● 进风口被异物堵塞。● 使用面积超过机器使用面积。	<ul style="list-style-type: none">● 请确定滤网是否安装到位。● 请及时更换滤网组件。● 请移除进风口异物。● 请在适合面积内使用。

- 如需要服务或购买过滤器等耗材，请联络顾客服务专线 4009-21-3058。

Consumer Warranty Card

消费者保修卡

Name 姓名			
Gender 性别	<input type="checkbox"/> Male 男士	<input type="checkbox"/> Female 女士	Mobile 行动电话
Address 住址			
E-mail 电子邮箱			
Product Name 产品名称		Model NO. 产品型号	
空气净化器		DK2	
Serial Number 产品序列号			
Date of Purchase 购买日期		Y 年	M 月
			D 日
Notes 备注			

保修说明:

在正确使用方式下,自购买日期起12个月内,如因制造商的瑕疵而发生故障则免费维修(不包含过滤器)。

* 一切人为损坏、天灾、地震、不在保证范围内。

* 产品保修期内,若需要维修,请拨打客户服务热线:4009-21-3058

* 若超过保修期限,则需酌收维修检测费用。

* 请妥善保管购机凭证,例如订购单、送货单等。

以下情况恕不保修:

* 无保修卡及有效凭证。

* 非本公司指定维修部维修而自行拆装修理引起的损坏。

* 跌落或使用不当造成损坏。

* 耗材类不在保修范围内。例如:过滤器、灯管和电池等。

在实施本公司保修标准过程中,我司保留以上条款的解释权。当您在接受或需要服务时有不明之处,请咨询我司客户服务热线。

* 保修服务区域仅限中国国内(不包含港、澳、台地区)。

QRcode
Here